

# TW-S-B10 Facade Attachment

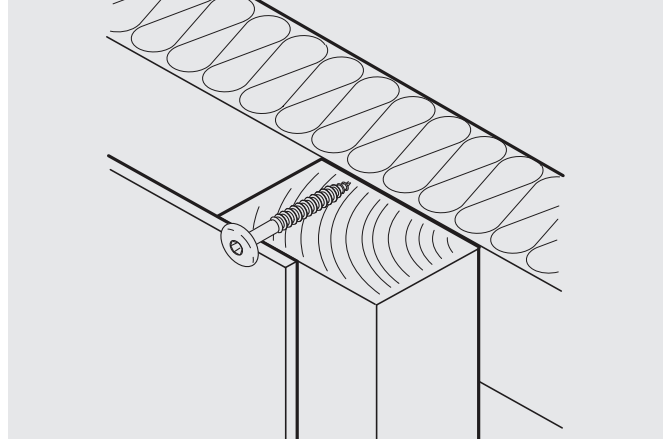

### Features and Benefits

- 304 Stainless steel provides maximum corrosion resistance.
- Flat bugle head allows for installation flush with the panel surface.
- Color matched Vista spray available to blend with facade panel.

### Application

Facade/cladding panel to wood

### Product Selection

Material No.	Fastener Length		Thread Length*		Description	Carton Wt. (lbs.)	Carton Qty.
	(in)	(mm)	(in)	(mm)			
1839866	1-1/2"	38	1.09"	28	TW-S-B10-4.8x38	2.5	250

\*Note - Thread length measured from tip of the drill point to end of threads.

# TW-S-B10 Facade Attachment

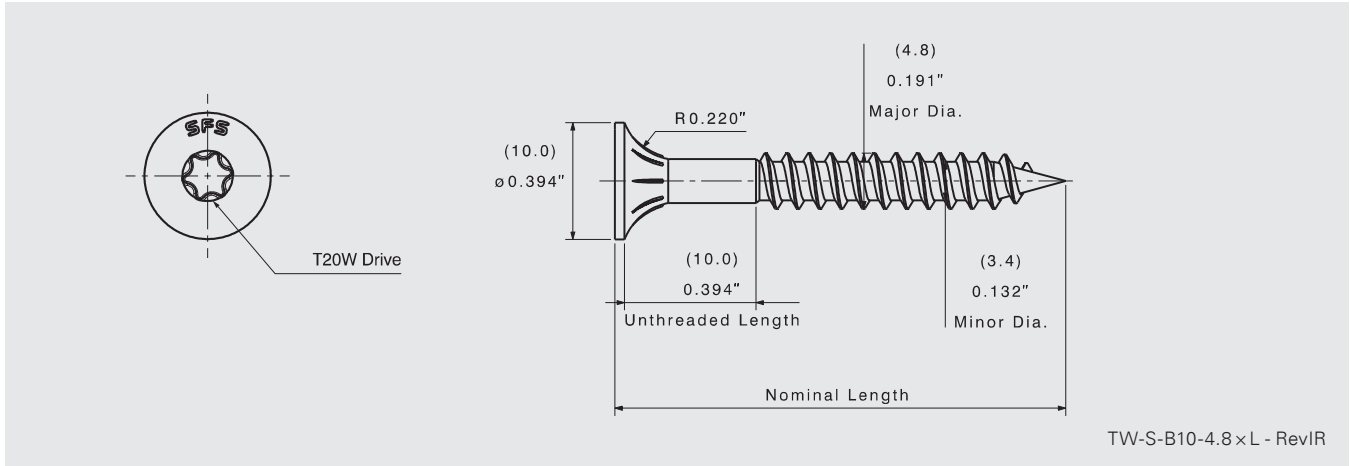

### Product Specifications

Diameter:	#10 (4.8 mm)	Drive:	T20W
Threads Per Inch:	12	Drill Point:	Type A
Head Style:	0.393" (10.0 mm) Bugle Head	Thread Major Dia:	0.191" (4.8 mm)
Material:	304SS	Thread Minor Dia:	0.132" (3.4 mm)

### Performance Data<sup>1,2,3</sup>

#### Material Strength

Tensile	1592 lbf / 7082 N
Shear	1214 lbf / 5400 N
Torsional	60 lbf-in / 6.6 N·m

#### Pull Out Strength Plywood

<b>3/4" (19.1 mm)</b>	578 lbf / 2571 N
<b>5/8" (15.9 mm)</b>	438 lbf / 1948 N
<b>1/2" (12.7 mm)</b>	348 lbf / 1548 N

#### Pull Out Strength OSB (Oriented Strand Board)

<b>23/32" (18.3 mm)</b>	449 lbf / 1997 N
<b>19/32" (15.1 mm)</b>	412 lbf / 1833 N
<b>7/16" (11.1 mm)</b>	228 lbf / 1014 N

#### Pull Out Strength

#### SYP Dimensional Lumber

<b>1x4</b>	481 lbf / 2140 N
------------	------------------

<sup>1</sup> SFS 4407.07

<sup>2</sup> CHTV 2016

<sup>3</sup> SFS 4450.08

### Installation and Application Considerations

Install fasteners with 0–2500 RPM screw gun equipped with depth sensing nose piece.

Use of T20W drive bit is required.

Fastener length should provide for a minimum of 1" (25.4 mm) penetration into wood substrate. Check with cladding panel manufacturer for specific installation guidelines.

**Use of impact guns or hammer drills is not recommended.**